

PLAN SHOWING THE PROPOSED SUB-DIVISION
 IN R/S NO 95/2B OF PEERKANKARANAI VILLAGE
 SAIDAPET TK. & CHENGALPATTU DIST.
 TAMBARAM SUB-REGISTRAR OFFICE. SCALE 1" = 16'0"

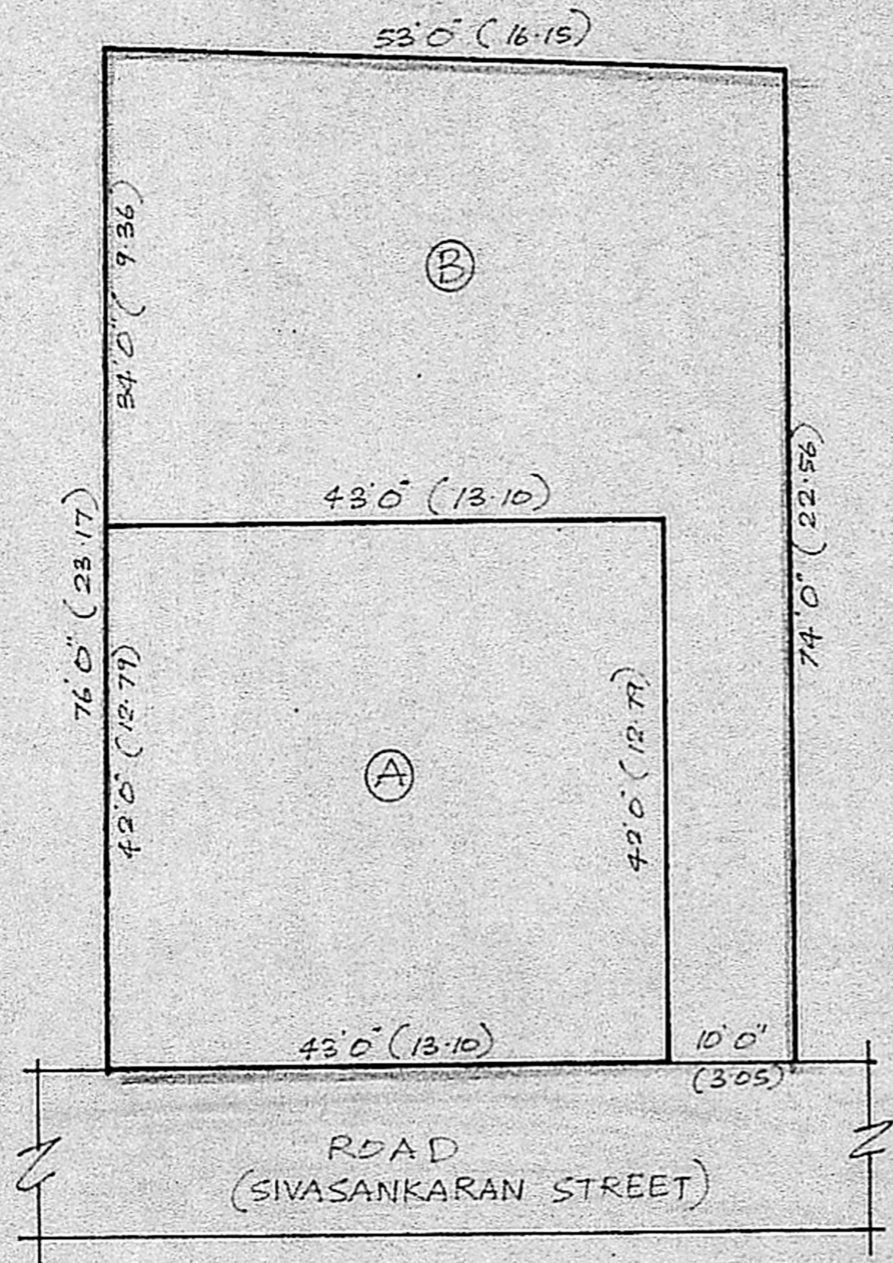

o/c

27/7/89
 175/89
 3/3

APPROVED
 VIDE Lr. No. D2(L)/847/89
 Dtd 7-89

P.P.D
 No: 175/89

FOR MEMBER SECRETARY
 MADRAS METROPOLITAN
 DEVELOPMENT AUTHORITY

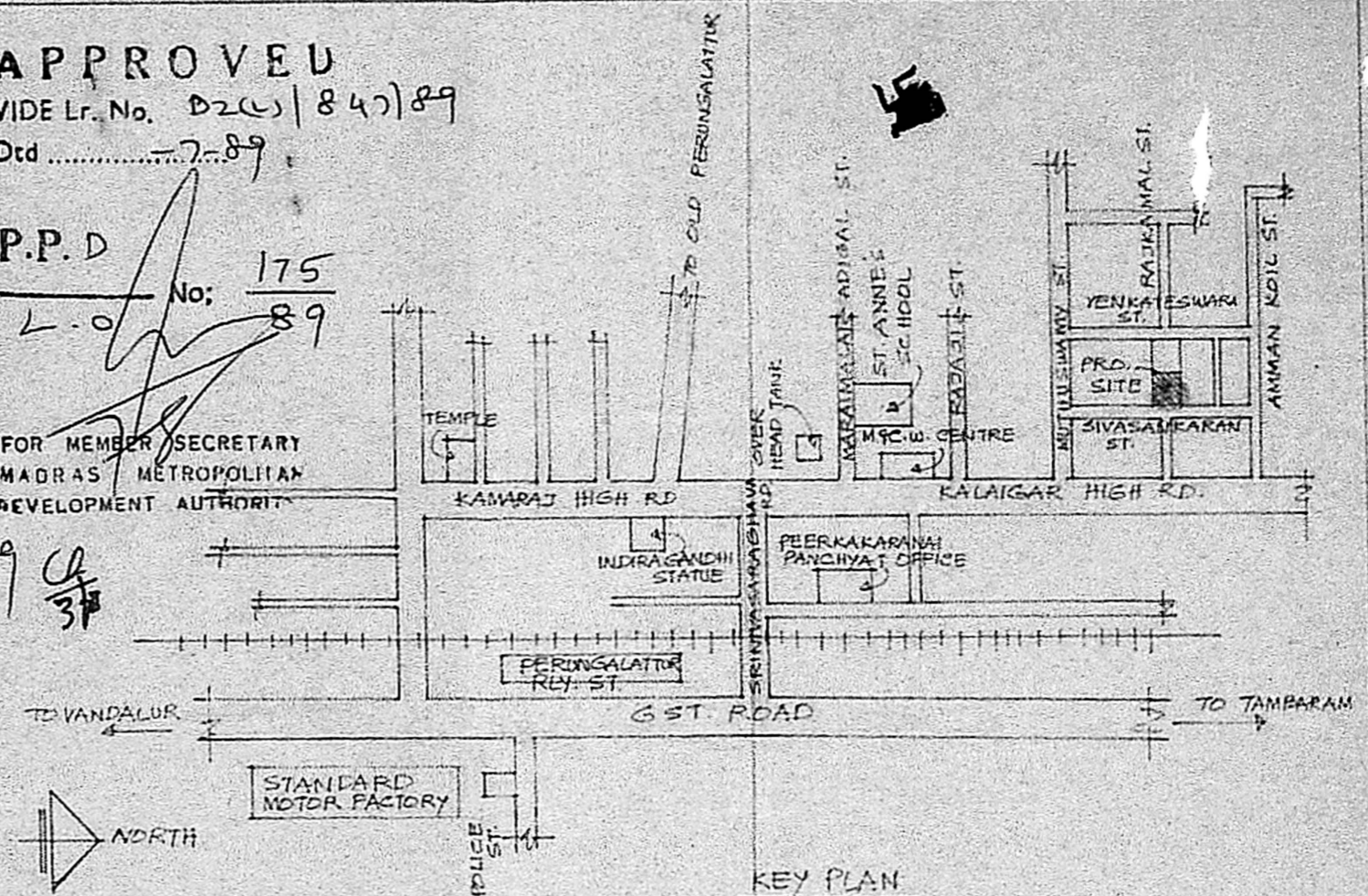

KEY PLAN
 NOT TO SCALE

NOTE:-

	SQ. FT.	SQ. M.
TOTAL EXTENT.	3975	369.19.
PORTION-A.	1806	167.54
PORTION-B.	2169	201.65
PROPOSED SUB-DIVISION	⊖	
EXISTING ROAD.	○	

S. Mathukrishnan

OWNER

V. Srinivasulu
 V. SRINIVASALU, L.C.E.
 Asst. Executive Engineer (Retd)
 Consulting Civil Engineer.
 REGD. No. 270.
 CLASS I LICENSED SURVEYOR
 CORPORATION OF MADRAS
 No. 60, Valluvar Road,
 ARUMBAKKAM. MADRAS-100

ENGINEER.